

Forestry Executive Committee Meeting Notes

April 15, 2016

8:00 a.m. – 9:00 a.m.

Richardson Hall 107

Members attending: Jim Johnson, Randy Rosenberger, Laurie Schimleck, Geoff Huntington, Woody Chung, John Bliss, Roger Admiral, Steve Tesch, Michael Collins, Claire Montgomery, Zak Hansen, Mike Altimus, Adrienne Wonhof, Troy Hall, Chris Knowles, Lisa Ganio, Steve Fitzgerald

Notes by Nathalie Gitt

Announcements:

- First Aid & CPR/AED Training – Steve Tesch gave an update on the attendance for the training. The session was filling up quickly. There is a waiting list for a second offering on May 18, to sign-up contact Jim Kiser.
- OSU President State of the University Address in Bend - Geoff Huntington was looking for suggestions of any Central Oregon achievements related to College of Forestry Extension, students, and partnership with local counties that can be highlighted in the President's speech. Jim Johnson and Steve Tesch will email Geoff some bullet points.

Presentation on Salvage and Deconstruction of Peavy this Summer – Mike Sloop, Project Manager, Walsh Construction

This was an opportunity for the Forestry Executive Committee to ask questions and hear about what is going to happen between July 1st and the start of Fall term.

Topics Covered:

- CoF decommission and deconstruction *
- Staging and demarcation
- Parking
- Transition from now until July 1st
- Move sequencing
- Start of construction – Late October

*** Slide 1:**

June:

- Spring term ends
- Move out of Peavy
- OSU remove artifact and items for reuse

July:

- Begin abatement (OSU)
- Set-up WCC Administrative office and temporary FIR Trailers
- Move Business office
- Relocate FIR
- Install temporary partition in the knuckle

- Disconnect Peavy power, mechanical and life/safety systems

August

- Begin deconstruction (8-10 wks)

***Slide 2:**

Decommission:

- Tree protection
- Disconnect and safe off utilities (power, steam, water, IT, etc...)
- Disconnect Fire Life Safety/BMS

Deconstruction

- Reinforcement of existing Peavy basement walls to support Richardson foundations and Moon Tree
- Deconstruction
 - o Divert from landfill approx. 88% (by Weight)
 - Reuse structure
 - Glulam beams, columns, purlens/decking
 - Recycle
 - Concrete, asphalt, rock reinforcing steel, wood, metal

Questions:

- 1) Identification of materials to reuse – Penny Wright and Roger Admiral will coordinate a plan for folks to identify things to reuse.
- 2) Retaining trees – long term impacts on the building
- 3) Staging of the construction of the AWP – no impacts on parking, more parking spaces will be designed.
- 4) Access to the building – The knuckle will be under heavy construction, temporary partition will be installed, the Richardson elevator will be in operation.
- 5) Disconnecting Power in Peavy – Mike Sloop noted during his presentation that there may be some hiccups in the process regarding retaining power and connection to Richardson since the systems are linked. Before this time everyone should be prepared for power, utility, and IT connectivity interruptions.
- 6) Richardson Hall roof – Getting bids, the work will be scheduled sometime in August, Sept, or October.
- 7) WCC (Walsh Construction Admin Office) and the FIR trailers (equipment for students) Access – graveled area for foot traffic only.

Next:

- 1) The next iteration of the design plan presentation and the costing estimate to get to the budget is scheduled on May 4.
- 2) Further discussion around the College of Forestry landscape need (research, teaching, demonstration, field technique instruction) and tree retention will be scheduled. Tribal members will be invited in the conversation.
- 3) The OSU arborist and Walsh Construction staff are meeting on April 20 regarding the protection of trees. Paul Ries will be invited to attend the meeting.

Attachement: Peavy Deconstruction Slides, Mike Sloop

College of Forestry Peavy Hall Decommissioning/Deconstruction

June

- Spring Term Ends
- Move out of Peavy
- OSU Remove Artifacts and Items for Reuse

July

- Begin Abatement (OSU)
- Set up WCC Admin and Temp FIR Trailers
- Move Business Office
- Relocate FIR
- Install Temporary Partitions in Knuckle
- Disconnect Peavy Power, Mechanical, Life/Safety Systems

August

- Begin Deconstruction (8-10 weeks)

LANDSCAPE NOTES:

1. ALL EXISTING TREES NOTED AS RETAINED SHALL BE PROTECTED IN PLACE AT EXISTING GRADES. SEE LT.00 TREE PROTECTION PLAN. EXISTING VEGETATION TO REMAIN OR TO BE TRANSPLANTED TO BE IDENTIFIED IN FIELD BY LANDSCAPE ARCHITECT PRIOR TO START OF CONSTRUCTION. EXCAVATION IN AREAS OF EXISTING LAWN SHALL BE PERFORMED BY HAND WITHIN THE DRIP LINE OF EXISTING TREES TO REMAIN. AT NO TIME SHALL EQUIPMENT OR MATERIALS BE STORED OR STOCKPILED WITHIN THE DRIP LINE OF ANY EXISTING TREES TO REMAIN. CONTRACTOR SHALL NOTIFY LANDSCAPE ARCHITECT IF ANY EXISTING TREES TO REMAIN WILL BE NEGATIVELY IMPACTED BY ANY REQUIRED TREE REMOVALS PRIOR TO START OF THAT WORK.
2. PROTECT ALL EXISTING SITE CONDITIONS NOT DESIGNATED FOR REMOVAL OR SALVAGE. ANY DAMAGE TO THESE ELEMENTS SHALL BE RESTORED BY THE CONTRACTOR AT THE CONTRACTOR'S OWN EXPENSE TO THEIR ORIGINAL CONDITION.
3. REMOVAL OF EXISTING SITE ELEMENTS NOTED AS SALVAGED IN PROJECT CONTRACT DOCUMENTS SHALL BE REMOVED AND RELINQUISHED TO OSU FOR STORAGE PRIOR TO DEMOLITION. CONTRACTOR SHALL REINSTALL SALVAGED SITE ELEMENTS PER CONTRACT DOCUMENTS.
4. THE LOCATION OF UNDERGROUND UTILITIES ARE SHOWN PER PHYSICAL FEATURES FOUND. RECORD INFORMATION OBTAINED FROM AND MARKINGS PLACED BY UTILITY COMPANIES. THE EXACT LOCATION OR COMPLETENESS OF UNDERGROUND INFORMATION SHOWN IN THESE DRAWINGS CANNOT BE GUARANTEED. CONTRACTOR TO VERIFY THE ACTUAL LOCATION OF ALL UTILITIES, FACILITIES, AND STRUCTURES PRIOR TO CONSTRUCTION. CONTRACTOR MUST CALL (1-800-424-5555) 72 HOUR IN ADVANCE OF ALL SUBGRADE WORK FOR UNDERGROUND UTILITY LOCATIONS.
5. PEDESTRIANS SHALL BE PROTECTED FROM EXCAVATION AND WORK AREAS AT ALL TIMES. PROVIDE SUITABLE BARRIERS AS REQUIRED. DO NOT BLOCK WALKS WITH STORAGE OF CONSTRUCTION EQUIPMENT OR MATERIALS.
6. IT IS THE CONTRACTOR'S RESPONSIBILITY TO UNDERSTAND, COORDINATE, AND SCHEDULE SEQUENCED PHASING OF

7. ANY DISCREPANCIES BETWEEN WHAT IS SHOWN ON THE CONTRACT DRAWINGS AND FIELD CONDITIONS SHALL BE BROUGHT TO THE ATTENTION OF THE LANDSCAPE ARCHITECT PRIOR TO COMMENCING WORK IN THAT AREA.
8. ALL MATERIALS, CONSTRUCTION METHODS AND WORKMANSHIP SHALL CONFORM TO THE APPLICABLE LAWS, RULES AND CODES OF THE MUNICIPALITY, COUNTY, AND STATE.
9. SPECIFIC LOCATIONS OF CONSTRUCTION FENCES, GATES, AND ENTRANCES SHALL BE COORDINATED WITH THE OWNERS REPRESENTATIVE.
10. THE CONTRACTOR SHALL KEEP THE WORK SITE FREE FROM DEBRIS AND ACCUMULATED REFUSE AND SHALL HAVE SOLE RESPONSIBILITY FOR PROTECTING ALL DANGEROUS AREAS FROM ENTRY BY UNAUTHORIZED PARTIES. PUBLICLY ACCESSIBLE AREAS WILL BE LEFT BROOM CLEAN AT THE END OF EACH WORKING DAY.
11. THE CONTRACTOR SHALL BE REQUIRED TO LEGALLY DISPOSE OF ALL DEBRIS AT A PERMITTED FACILITY.
12. SEE CIVIL DRAWINGS FOR SITE UTILITIES AND VEHICULAR AREA PAVEMENTS.
13. SEE ELECTRICAL DRAWINGS FOR SITE LIGHTING.
14. SEE ARCHITECTURAL DRAWINGS FOR BUILDING LAYOUT.
15. SEE L1.01 AND L1.02 FOR GRADING.
16. SITE IRRIGATION SHALL BE A COMBINATION OF DRIP AND SPRAY IRRIGATION OVER ALL PROPOSED PLANTING AREAS (EXCLUDES EXISTING ARBORETUM AREA). IRRIGATION SHALL CONFORM TO ALL OSU CONSTRUCTION STANDARDS.

Jefferson St.

FOREST SERVICE LEASE LIMIT LINE

FIR

WCC

L1.01

NEW PEAVY HALL

ATRIVM

ENTRY PLAZA EAST

WET/DRY LAB COURT

RICHARDSON HALL

RICHARDSON WORK YARD

DRYDEN HALL

TRUCK ACCESS (SEE CIVIL)

AWP

AWP ENTRY PLAZA

L1.02

WORK YARD 17,108 SF

STORAGE 2,130 SF

DAIRY BARN

LABORATORY ANIMAL RESOURCE CENTER

VETERINARY RESEARCH LAB

Washington Way

SW WASHINGTON WAY

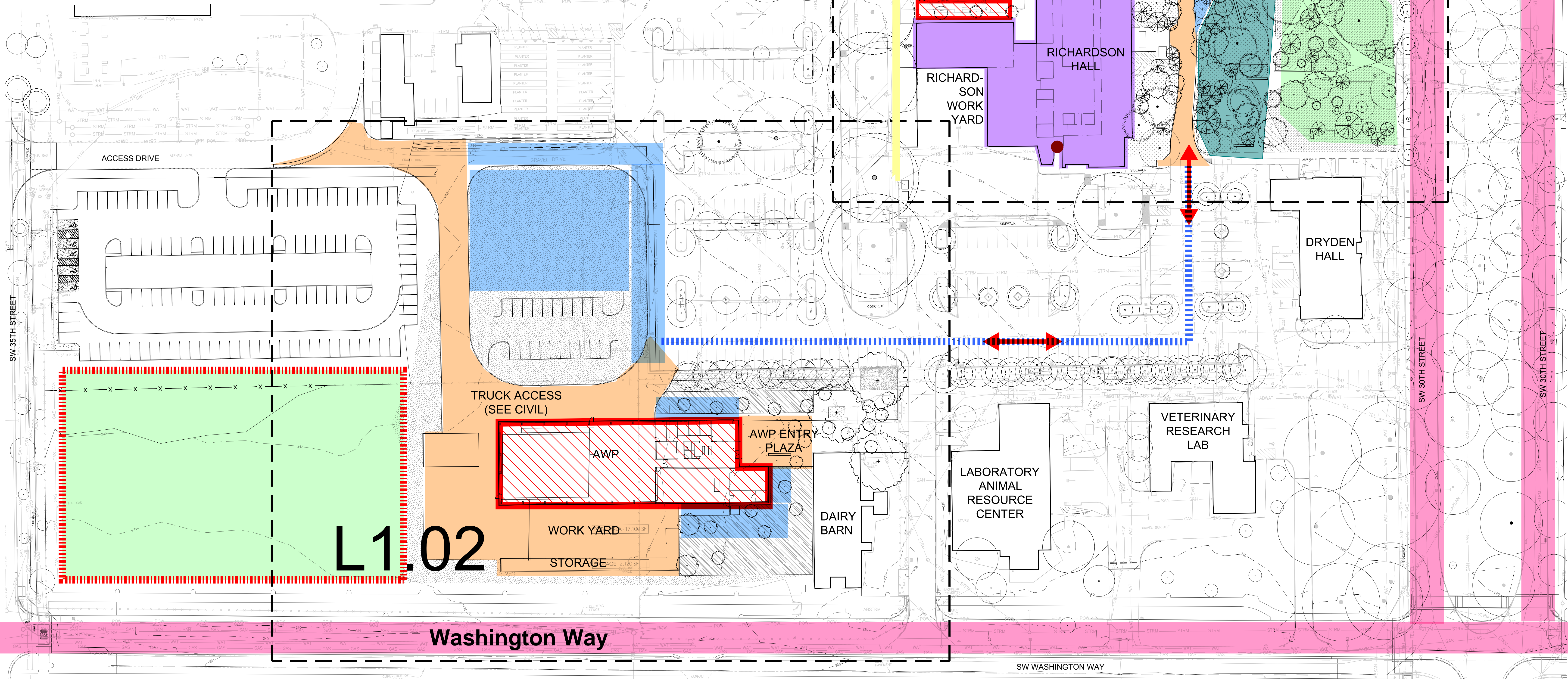

LANDSCAPE PLAN

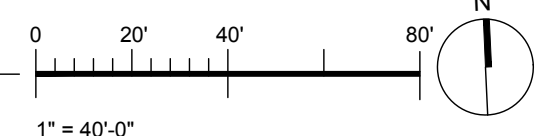

No.	Description	Date
1	Issued for 50% SD	2015.1
2	Issued for 80% SD	2015.1
3	Issued for 100% SD	2015.1

PLANTING LIST: 1/20/2015 1:46 PM: C:\PROJECTS\NEW PEAVY BUILDING\LANDSCAPE\LANDSCAPE.LIN

SALVAGE + DEMOLITION GENERAL NOTES

- DRAWINGS TO BE PLOTTED IN COLOR.
- ARCHITECTURAL DEMOLITION DRAWINGS ILLUSTRATE A GENERAL SCOPE OF WORK. IT IS THE RESPONSIBILITY OF THE CONTRACTOR TO DETERMINE THE FULL SCOPE OF THE DEMOLITION REQUIRED USING EXISTING SITE CONDITIONS AND CONTRACT DOCUMENTS.
- REFER TO CONSULTANT DRAWINGS AND THE FOLLOWING SPECIFICATION SECTIONS AND ALL RELATED SECTIONS FOR ADDITIONAL INFORMATION:
 - 0136 89 - TREE AND PLANT PROTECTION
 - 0241 13 - SELECTIVE DEMOLITION
 - 0241 19 - SELECTIVE DEMOLITION
- RICHARDSON HALL BUILDING WILL BE OCCUPIED ON ALL LEVELS DURING PEAVY HALL SALVAGE AND DEMOLITION.
 - CONTRACTOR TO PROVIDE WATERPROOFING, TEMPORARY ENCLOSURE AND SOUND INSULATION TO ENSURE RESIDENT ACCESS AND MAINTAIN WORKING INDOOR TEMPERATURE, AIR QUALITY AND ACOUSTIC CONDITIONS.
 - EXTENT AND DIMENSION OF CONSTRUCTION PARTITIONS TO BE COORDINATED WITH ARCHITECT.
 - EXISTING RICHARDSON HALL MECHANICAL, ELECTRICAL AND LIFE SAFETY SYSTEMS TO REMAIN OPERATIONAL DURING DEMOLITION AND CONSTRUCTION.
- CONTRACTOR TO ENGAGE A SPECIALTY ENGINEER TO PREPARE A DEMOLITION PLAN, ENGINEER TO STAMP DRAWINGS AND COMPLETE A COMMITMENT TO GENERAL REVIEW FORM FOR DEMOLITION.
- CONTRACTOR TO ENGAGE SPECIALTY ENGINEER TO ENSURE STRUCTURES TO REMAIN ARE ADEQUATELY SUPPORTED PRIOR TO AND DURING SALVAGE AND DEMOLITION. CONTRACTOR TO MAKE GOOD ALL INTERFACES BETWEEN EXISTING STRUCTURES IDENTIFIED AS TO BE REMOVED AND EXISTING STRUCTURES IDENTIFIED TO REMAIN.
- HAZARDOUS MATERIALS ARE REPORTED TO BE PRESENT IN THE EXISTING PEAVY HALL BUILDING. A COPY OF THE PRESENCE OF HAZARDOUS MATERIALS IS ON FILE FOR REVIEW AND USE.
 - NOTE THAT WOOD-BASED ELEMENTS - NOTED FOR SALVAGE AND REUSE IN NEW CONSTRUCTION MAY BE REFERRED TO IN THIS REPORT.
- PROTECT ALL CLADDING AND FLASHING CONDITIONS AT JUNCTION OF EXISTING RICHARDSON HALL FROM DAMAGE FOR DURATION OF SALVAGE AND DEMOLITION.
 - ENSURE BUILDING ENVELOPE CONTINUITY IS MAINTAINED THROUGHOUT DEMOLITION AND CONSTRUCTION.
- NEW OPENINGS FOR SERVICE PENETRATIONS TO BE COORDINATED WITH MECHANICAL - ELECTRICAL PRIOR TO DEMOLITION.
- ALL DIMENSIONS ARE TO BE DETERMINED USING THE ARCHITECTURAL ISSUED FOR CONSTRUCTION DRAWINGS AND ARE NOT TO BE INFERRED FROM THE DEMOLITION DRAWINGS. REFER TO ARCHITECTURAL DRAWINGS FOR LOCATION AND DIMENSION OF NEW OPENINGS FOR DOORS AND FIRE SHUTTERS. DIMENSIONS ON DEMOLITION DRAWINGS PROVIDED FOR PRICING ONLY.
- REFER TO A066 FOR INVENTORY LIST OF MATERIALS TO BE SALVAGED AND USED IN NEW CONSTRUCTION.
 - CAREFULLY SALVAGE IN A MANNER TO PREVENT DAMAGE.
 - ITEMS INDICATED FOR REUSE WITHIN THE BUILDING TO BE STORED BY THE CONTRACTOR, PREPARED FOR REUSE AND INSTALLATION. ALL OTHER ITEMS TO BE PROMPTLY RETURNED TO THE OWNER.
 - REFER TO EXISTING PEAVY HALL BUILDING DRAWINGS FOR EXTENTS OF WOOD-BASED MATERIALS.
 - ONCE THE STRUCTURE IS EXPOSED, KING AND EQUILIBRIUM CONSULTING SHALL REVIEW THE STRUCTURAL ELEMENTS IN PERSON AND SURFACE WITH THE CONTRACTOR TO PROVIDE FURTHER INSTRUCTION ON ELEMENTS THAT SHALL BE SALVAGED FOR STRUCTURAL / ARCHITECTURAL APPLICATION. REFER TO KING AND EQUILIBRIUM PHOTOGRAPHS SHOWING HALFWAY ELEVATIONS AS INDICATED BY THE ELEVATION MARKS.
 - REFER TO OSU'S SALVAGE DEMO APPENDIX FOR ADDITIONAL DOCUMENTATION OF ARTIFACTS AND WOOD ELEMENTS WITHIN THE EXISTING BUILDING.
 - THIS PHOTOGRAPHIC DOCUMENTATION IS PROVIDED FOR REFERENCE ONLY. CONTRACTOR TO PROVIDE DOCUMENTATION OF ALL SALVAGED ITEMS AND ELEMENTS PER SPECIFICATION.
- SUBMIT LIST OF ITEMS THAT HAVE BEEN REMOVED AND SALVAGED, INCLUDING DIMENSIONS AND CONDITIONS FOR ALL WOOD ELEMENTS INDICATED FOR POTENTIAL REUSE.
 - NOTIFY CONSULTANT OF ALL WOOD-BASED MATERIALS INDICATED FOR REUSE THAT MAY REQUIRE ABATEMENT.
- CONTRACTOR TO MAKE EFFORTS TO MINIMIZE WASTE TO LANDFILL. CONTRACTOR TO TRACK THE WEIGHT OF ITEMS:
 - SALVAGED FOR REUSE IN NEW CONSTRUCTION
 - DIVERTED FROM LANDFILL / RECYCLED
 - ABATED MATERIALS
 - SENT TO LANDFILL

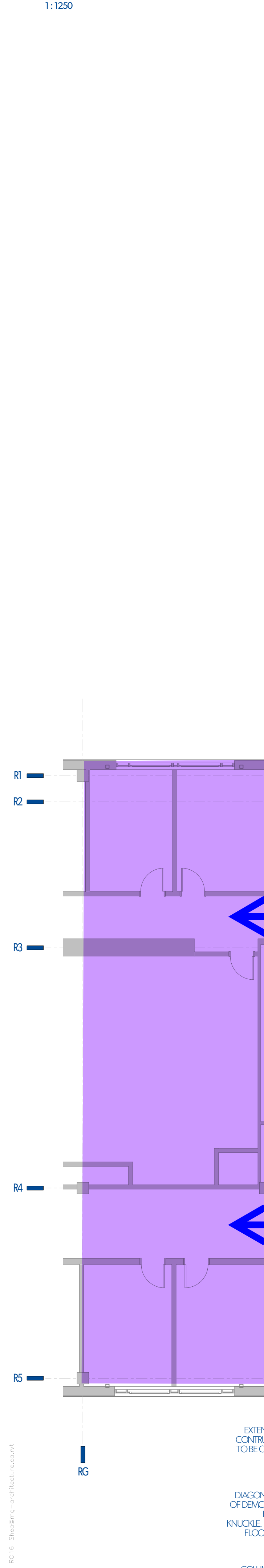
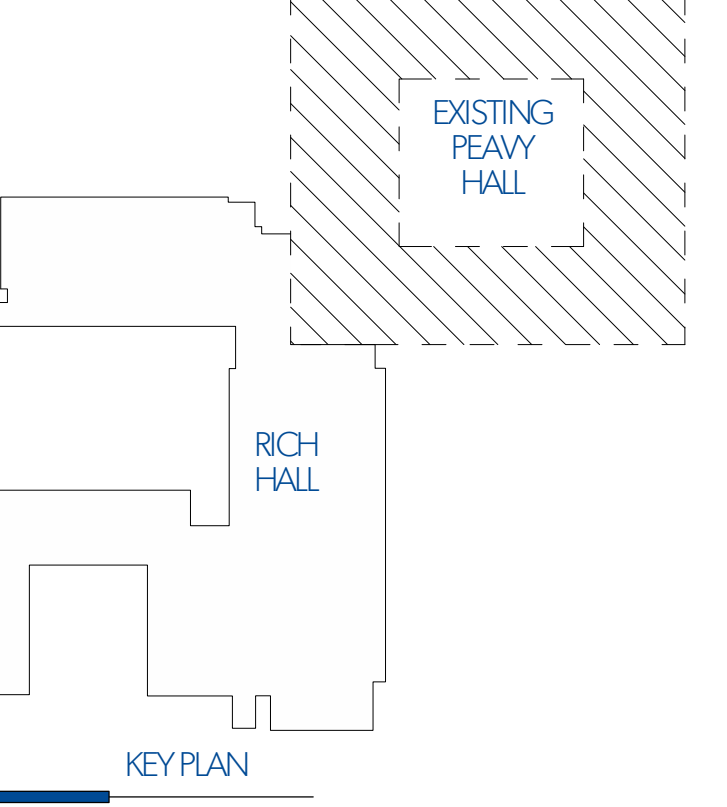

1st Floor

Richardson

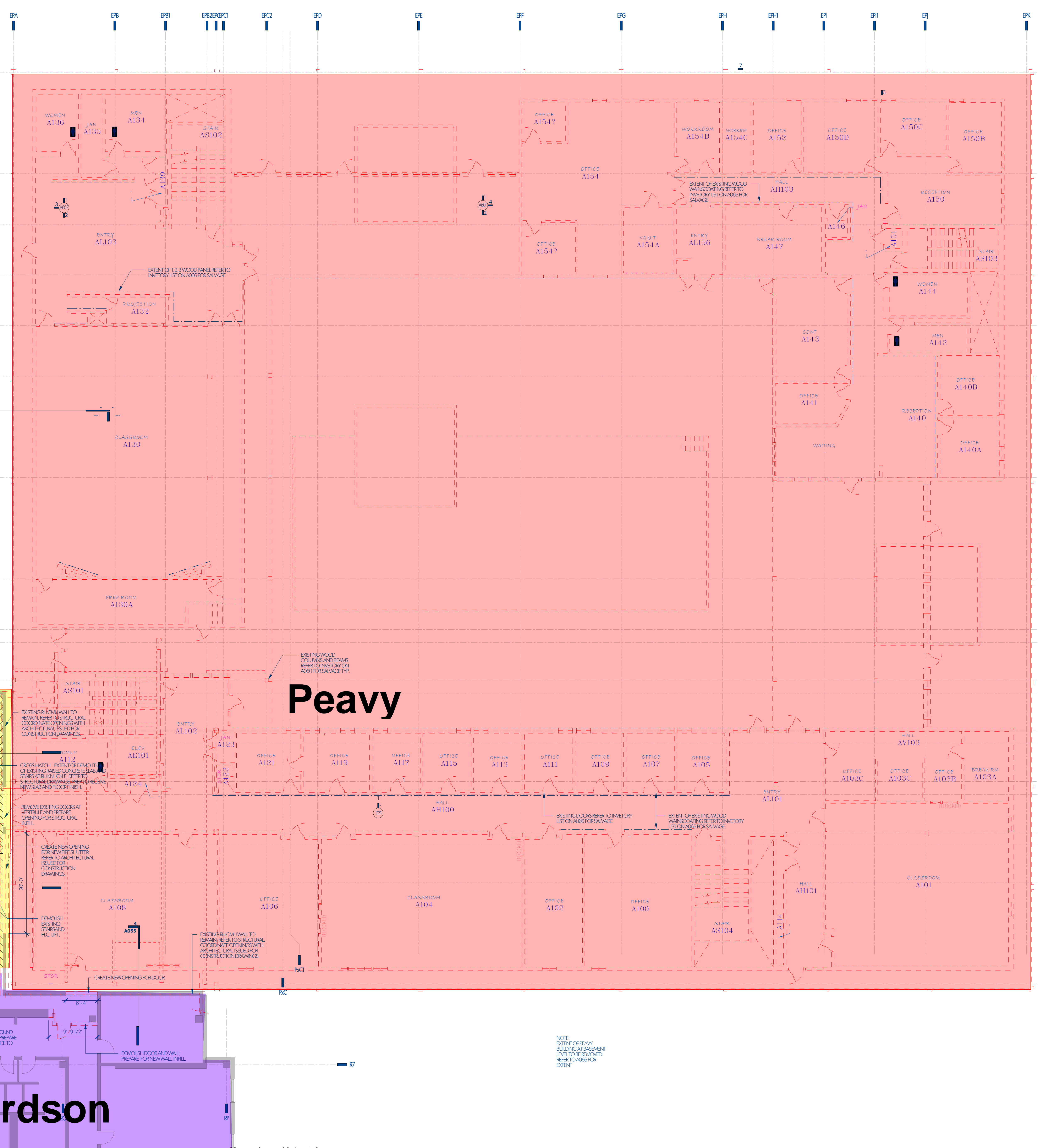

SALVAGE AND DEMO LEGEND

	EXISTING TO REMAIN
	EXISTING TO BE REMOVED
	*REFER TO A066 FOR INVENTORY LIST OF SALVAGED MATERIALS
	EXTENT OF FLOOR FINISH TO BE REMOVED
	FLOOR FINISH AND STRUCTURE TO BE REMOVED (SEE STRUCTURAL)
	WANSKOATING
	WOOD PANEL

NOT FOR CONSTRUCTION

PEAVY BUILDING

OSU FOREST SCIENCE COMPLEX | CORVALLIS, OREGON

BID PACKAGE 01- SALVAGE + DEMO

08 APRIL 2016

No.	Description	Date
Issue Date:		08 APRIL 2016
Drawn:	JG	
Checked:	ST	
MGA Project No.:		2014-022

EXIST PEAVY L1 SALVAGE+DEMO A052

Hazardous Material

SALVAGE AND DEMO LEGEND

- EXISTING TO REMAIN
- EXISTING TO BE REMOVED
- *REFER TO A066 FOR INVENTORY LIST OF SALVAGED MATERIALS
- EXTENT OF FLOOR FINISH TO BE REMOVED
- FLOOR FINISH AND STRUCTURE TO BE REMOVED/SEE STRUCTURAL
- WANSICOATING
- WOOD PANEL

NOT FOR CONSTRUCTION

PEAVY BUILDING

OSU FOREST SCIENCE COMPLEX | CORVALLIS, OREGON

BID PACKAGE 01- SALVAGE + DEMO

08 APRIL 2016

SALVAGE + DEMOLITION GENERAL NOTES

- DRAWINGS TO BE PLOTTED IN COLOR.
- ARCHITECTURAL DEMOLITION DRAWINGS ILLUSTRATE A GENERAL SCOPE OF WORK. IT IS THE RESPONSIBILITY OF THE CONTRACTOR TO DETERMINE THE FULL SCOPE OF THE DEMOLITION REQUIREMENTS BASED ON EXISTING SITE CONDITIONS AND CONTRACT DOCUMENTS.
- REFER TO CONSULTANT DRAWINGS AND THE FOLLOWING SPECIFICATION SECTIONS AND ALL RELATED SECTIONS FOR ADDITIONAL INFORMATION:
 - 02.06.00 - TREE AND PLANT PROTECTION
 - 02.41.13 - SELECTIVE SITE DEMOLITION
 - 02.41.19 - SELECTIVE DEMOLITION
- RICHARDSON HALL BUILDING WILL BE OCCUPIED ON ALL LEVELS DURING PEAVY HALL SALVAGE AND DEMOLITION.
 - CONTRACTOR TO PROVIDE WATERPROOFING, TEMPORARY ENCLOSURE AND SOUND INSULATION TO ENSURE ZERO WATER INGRESS AND MAINTAIN WORKING INDOOR TEMPERATURE, AIR QUALITY AND ACOUSTIC CONDITIONS.
 - EXTENT AND DIMENSION OF CONSTRUCTION PARTITIONS TO BE COORDINATED WITH ARCHITECT.
 - EXISTING RICHARDSON HALL MECHANICAL, ELECTRICAL AND LIFE SAFETY SYSTEMS TO REMAIN OPERATIONAL DURING DEMOLITION AND CONSTRUCTION.
- CONTRACTOR TO ENGAGE A SPECIALTY ENGINEER TO PREPARE A DEMOLITION PLAN, ENGINEER TO COSTUM DRAWINGS AND COMPLETE A COMMITMENT TO GENERAL REVIEW FORM FOR DEMOLITION.
- CONTRACTOR TO ENGAGE SPECIALTY ENGINEER TO ENSURE STRUCTURES TO REMAIN ARE ADEQUATELY SUPPORTED PRIOR TO AND DURING SALVAGE AND DEMOLITION. CONTRACTOR TO MAKE GOOD ALL INTERFACES BETWEEN EXISTING STRUCTURES IDENTIFIED AS TO BE REMOVED AND EXISTING STRUCTURES TO REMAIN.
- HAZARDOUS MATERIALS ARE REPORTED TO BE PRESENT IN THE EXISTING PEAVY HALL BUILDING. A REPORT ON THE PRESENCE OF HAZARDOUS MATERIALS IS ON FILE FOR REVIEW AND USE.
 - NOTE THAT WOOD-BASED ELEMENTS - NOTED FOR SALVAGE AND REUSE - IN NEW CONSTRUCTION MAY BE REFERRED TO IN THIS REPORT.
- PROTECT ALL CLADDING AND FLASHING CONDITIONS AT JUNCTION OF EXISTING RICHARDSON HALL FROM DAMAGE FOR DURATION OF SALVAGE AND DEMOLITION.
 - ENSURE BUILDING ENVELOPE CONTINUITY IS MAINTAINED THROUGHOUT DEMOLITION AND CONSTRUCTION.
- NEW OPENINGS FOR SERVICE PENETRATIONS TO BE COORDINATED WITH MECHANICAL - ELECTRICAL PRIOR TO DEMOLITION.
- ALL DIMENSIONS ARE TO BE DETERMINED USING THE ARCHITECTURAL ISSUED FOR CONSTRUCTION DRAWINGS AND ARE NOT TO BE INFERRED FROM THE DEMOLITION DRAWINGS. REFER TO ARCHITECTURAL IFC DRAWINGS FOR LOCATION AND DIMENSION OF NEW OPENINGS FOR DOORS AND FIRE SHUTTERS. DIMENSIONS ON DEMOLITION DRAWINGS PROVIDED FOR PRICING ONLY.
- REFER TO A066 FOR INVENTORY LIST OF MATERIALS TO BE SALVAGED AND USED IN NEW CONSTRUCTION.
 - CAREFULLY SALVAGE IN A MANNER TO PREVENT DAMAGE.
 - ITEMS INDICATED FOR REUSE WITHIN THE BUILDING TO BE STORED BY THE CONTRACTOR, PREPARED FOR REUSE AND INSTALLATION. ALL OTHER ITEMS TO BE PROMPTLY RETURNED TO THE OWNER.
 - REFER TO EXISTING PEAVY HALL BUILDING DRAWINGS FOR EXTENTS OF WOOD-BASED MATERIALS.
 - ONCE THE STRUCTURE IS EXPOSED, A SQA AND EQUILIBRIUM CONSULTING SHALL REVIEW THE STRUCTURAL ELEMENTS IN PLACE AND SURFACE WITH THE CONTRACTOR TO PROVIDE FURTHER INSTRUCTION ON ELEMENTS THAT SHALL BE SALVAGED FOR STRUCTURAL / ARCHITECTURAL APPLICATION.
 - REFER TO A066 AND A068 FOR PHOTOGRAPHS SHOWING HALFWAY ELEVATIONS AS INDICATED BY THE ELEVATION MARKERS.
 - REFER TO OSU SALVAGE DEMO APPENDIX FOR ADDITIONAL DOCUMENTATION OF ARTIFACTS AND WOOD ELEMENTS WITHIN THE EXISTING BUILDING.
 - THIS PHOTOGRAPHIC DOCUMENTATION IS PROVIDED FOR REFERENCE ONLY. CONTRACTOR TO PROVIDE DOCUMENTATION OF ALL SALVAGED ITEMS AND ELEMENTS PER SPECIFICATION.
- SUBMIT A LIST OF ITEMS THAT HAVE BEEN REMOVED AND SALVAGED, INCLUDING DIMENSIONS AND CONDITIONS FOR ALL WOOD ELEMENTS INDICATED FOR POTENTIAL REUSE.
 - NOTIFY CONSULTANT OF ALL WOOD-BASED MATERIALS INDICATED FOR REUSE THAT MAY REQUIRE ABATEMENT.
- CONTRACTOR TO MAKE EFFORTS TO MINIMIZE WASTE TO LANDFILL. CONTRACTOR TO TRACK THE WEIGHT OF ITEMS:
 - SALVAGED FOR USE IN NEW CONSTRUCTION
 - DIVERSED FROM LANDFILL / RECYCLED
 - ABATED MATERIALS
 - SENT TO LANDFILL

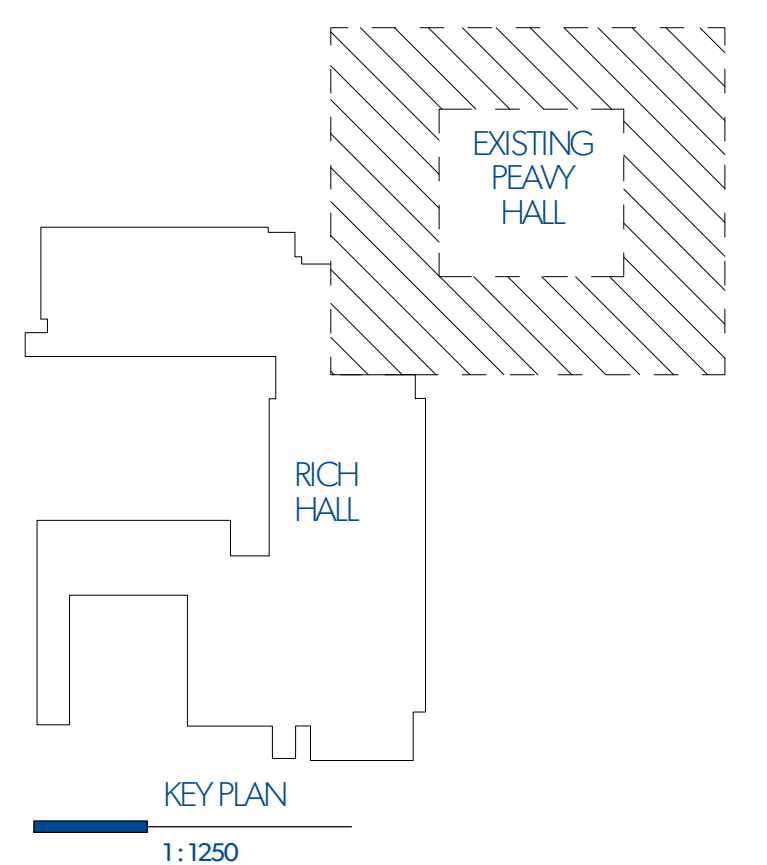

3rd Floor

Richardson

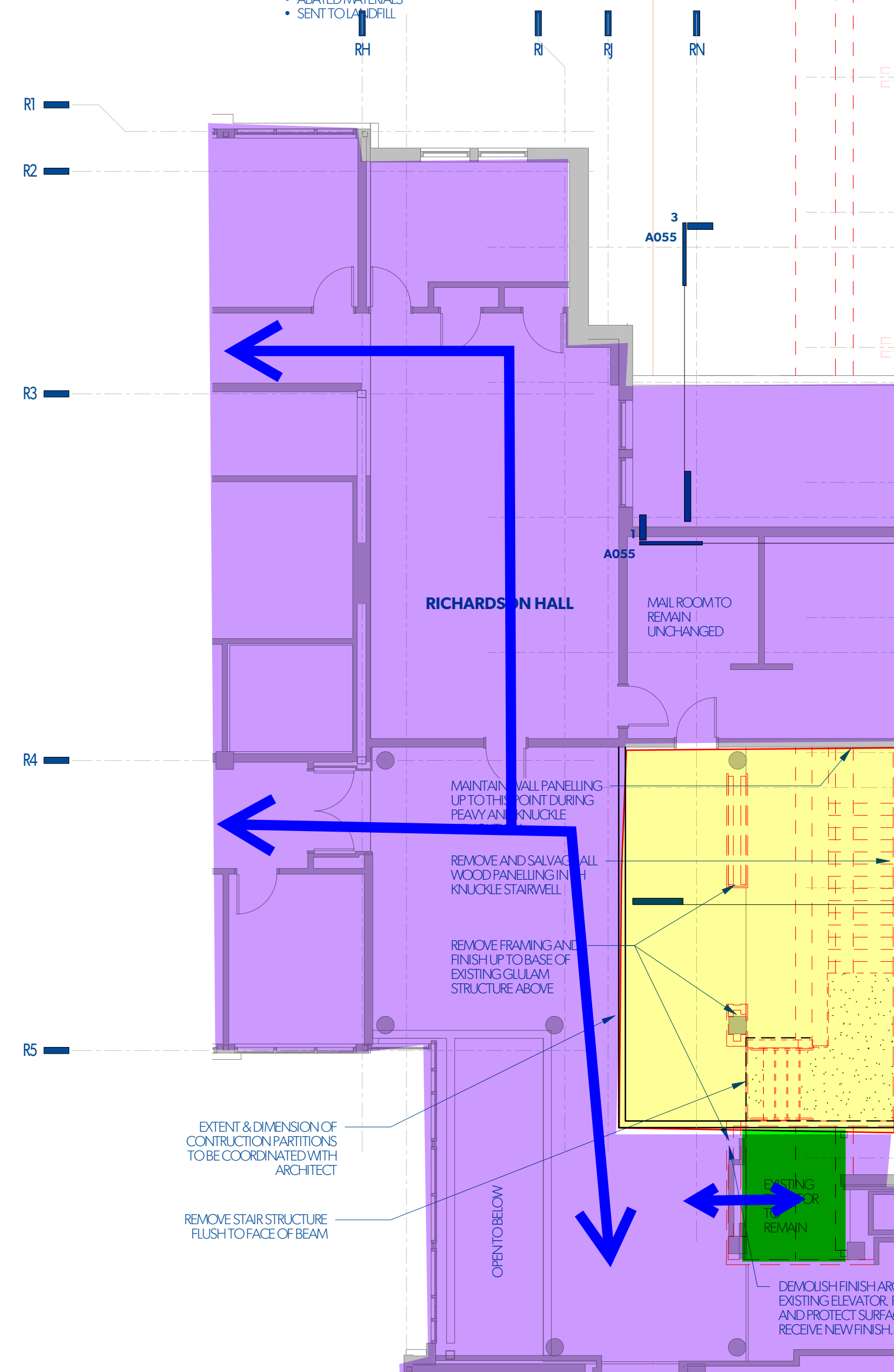
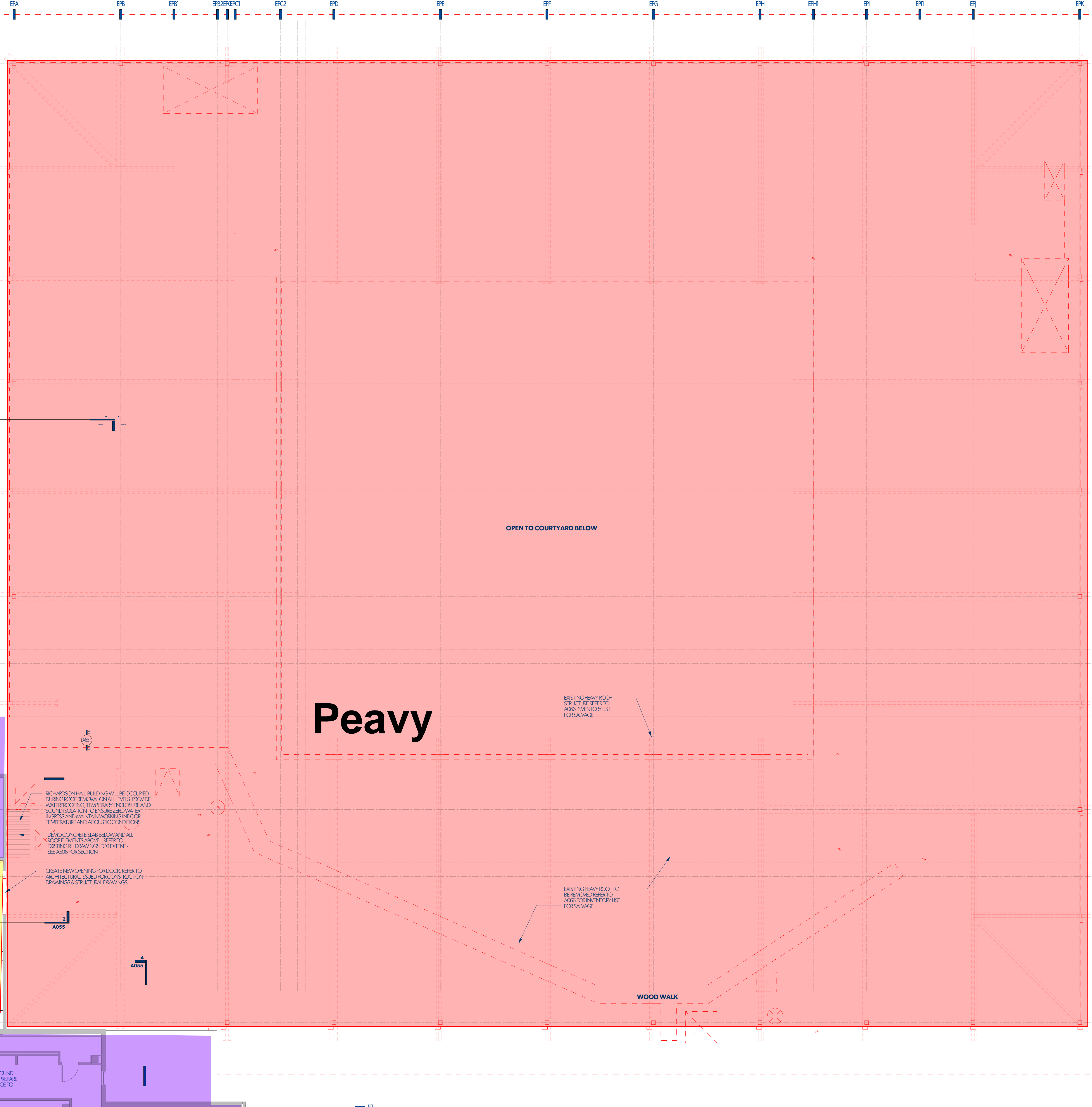

RICHARDSON HALL BUILDING WILL BE OCCUPIED DURING REMOVAL ON ALL LEVELS. PROVIDE WATERPROOFING, TEMPORARY ENCLOSURE AND SOUND INSULATION TO ENSURE ZERO WATER INGRESS AND MAINTAIN WORKING INDOOR TEMPERATURE AND ACOUSTIC CONDITIONS.

DEMO CONCRETE SLAB BELOW AND ALL ROOF ELEMENTS ABOVE - REFER TO EXISTING IFC DRAWINGS FOR EXTENT. SEE A066 FOR SECTION.

CREATE NEW OPENING FOR DOOR. REFER TO ARCHITECTURAL ISSUED FOR CONSTRUCTION DRAWINGS & STRUCTURAL DRAWINGS.

DEMOUSH FINISH AROUND EXISTING ELEVATOR. PREPARE AND PROTECT SURFACE TO RECEIVE NEW FINISH.

No.	Description	Date
Issue Date:		08 APRIL 2016
Drawn:	SM	
Checked:	Checker	
MGA Project No.:	2014-022	

EXIST PEAVY ROOF + RH L3 SALVAGE+DEMO
A054

College of Forestry Peavy Hall Decommissioning/Deconstruction

Decommission

- Tree Protection
- Disconnect and Safe Off Utilities (Power, Steam, Water, IT, etc)
- Disconnect Fire Life Safety/BMS

Deconstruction

- Reinforcement of existing Peavy basement walls to support Richardson Foundations and Moon Tree
- Deconstruction
 - Divert from Landfill approx 88% (by Weight)
 - Reuse Structure
 - Glulam Beams, Columns, Purlens/Decking,
 - Recycle
 - Concrete, Asphalt, Rock, Reinforcing Steel, Wood, Metal